

Laminate Furniture

When quoting your furniture, we will layout all the components you need on laminate sheets in the most efficient way to reduce waste and cost. Our laminate furniture is made-to-order and assembled in our Tigard, Oregon wood shop.

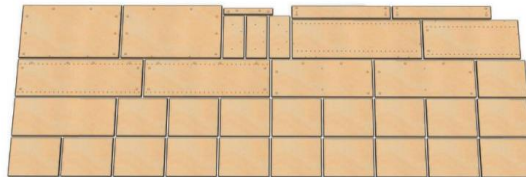

Finishing

Our standard laminates have 3mm square edge and thin tape banding and are matched to the surface finish unless otherwise indicated.

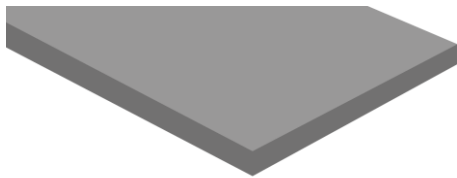

Optional on all surfaces

Grommets or Scallops

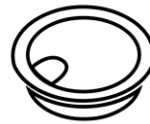

Measuring

Laminate furniture is measured from left to right

Model #	Depth	Width
WS-3660	36	60

① ②

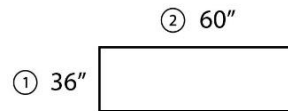

Model #	Column1	Depth	Width
WS-ECDS24-3660-24	24/24	36/60	

① ② ③ ④

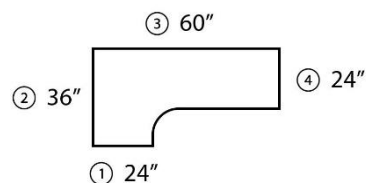

Assembly

Full assembly is standard on most items

Rectangle



Rectangle		
Model #	Depth	Width
WS-2024	20	24
WS-2030	20	30
WS-2036	20	36
WS-2042	20	42
WS-2048	20	48
WS-2054	20	54
WS-2060	20	60
WS-2066	20	66
WS-2072	20	72
WS-2078	20	78
WS-2084	20	84
WS-2090	20	90
WS-2096	20	96

WS-2424	24	24
WS-2430	24	30
WS-2436	24	36
WS-2442	24	42
WS-2448	24	48
WS-2454	24	54
WS-2460	24	60
WS-2466	24	66
WS-2472	24	72
WS-2478	24	78
WS-2484	24	84
WS-2490	24	90
WS-2496	24	96

WS-3030	30	30
WS-3036	30	36
WS-3042	30	42
WS-3048	30	48
WS-3054	30	54
WS-3060	30	60
WS-3066	30	66
WS-3072	30	72
WS-3078	30	78
WS-3084	30	84
WS-3090	30	90
WS-3096	30	96

Rectangle		
Model #	Depth	Width
WS-3636	36	36
WS-3642	36	42
WS-3648	36	48
WS-3654	36	54
WS-3660	36	60
WS-3666	36	66
WS-3672	36	72
WS-3678	36	78
WS-3684	36	84
WS-3690	36	90
WS-3696	36	96

WS-4848	48	48
WS-4860	48	60
WS-4872	48	72
WS-4884	48	84
WS-4896	48	96

WS-6060	60	60
WS-6072	60	72
WS-6084	60	84
WS-6096	60	96

Notes		
• Standard Depths: 24", 30", 36", 48", or 60"		

Round

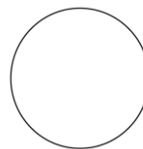

Round	
Model #	Diameter
WS-R24	24
WS-R30	30
WS-R36	36
WS-R42	42
WS-R48	48
WS-R54	54
WS-R60	60

Extended Corner

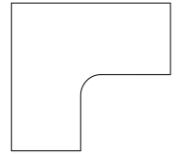

Extended Corner		
Model #	Depth	Width
WS-EC24-3648-24	36	48
WS-EC24-3660-24	36	60
WS-EC24-3672-24	36	72
WS-EC24-3684-24	36	84
WS-EC24-3696-24	36	96

WS-EC24-4848-24	48	48
WS-EC24-4860-24	48	60
WS-EC24-4872-24	48	72
WS-EC24-4884-24	48	84
WS-EC24-4896-24	48	96

WS-EC24-6060-24	60	60
WS-EC24-6072-24	60	72
WS-EC24-6084-24	60	84
WS-EC24-6096-24	60	96

Notes		
• Standard Depth: 24"		
• 30" depth requires minimum 42" width		

Standard Corner

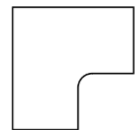

Standard Corner		
Model #	Depth	Width
WS-SC24-3636-24	36	36
WS-SC24-4242-24	42	42
WS-SC24-4848-24	48	48
WS-SC30-3636-30	36	36
WS-SC30-4242-30	42	42
WS-SC30-4848-30	48	48
WS-SC30-3636-24	36	36
WS-SC30-4242-24	42	42
WS-SC30-4848-24	48	48
WS-SC24-3636-30	36	36
WS-SC24-4242-30	42	42
WS-SC24-4848-30	48	48