

## Laminate Furniture

When quoting your furniture, we will layout all the components you need on laminate sheets in the most efficient way to reduce waste and cost. Our laminate furniture is made-to-order and assembled in our Tigard, Oregon wood shop.

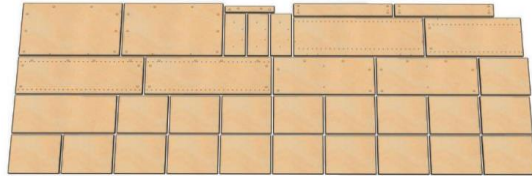

## Finishing

Our standard laminates have 3mm square edge and thin tape banding and are matched to the surface finish unless otherwise indicated.

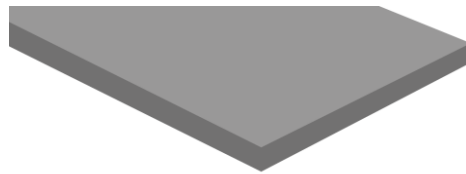

## Measuring

Laminate furniture is measured from left to right

Model #	Depth	Width
WS-3660	36	60

① ②

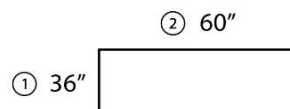

Model #	Depth	Width
WS-ECDS24-3660-24	24/24	36/60

① ② ③ ④

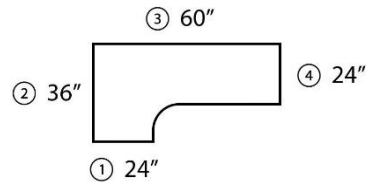

## Assembly

Full assembly is standard on most items

### Standard Pedestal

Model Number	Depth	Width	Height	Notes
WS-PD-FF	21	16	27.5	
WS-PD-BBF	21	16	27.5	

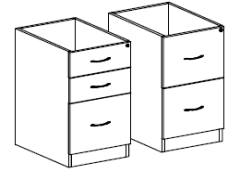

### Free Standing Pedestal

Model Number	Depth	Width	Height	Notes
WS-FS-FF	21	16	28.25	• 3/4" top standard, optional 1 1/8" top to equal 29" height
WS-FS-BBF	21	16	28.25	

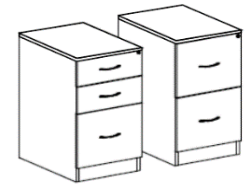

### Mobile Pedestal

Model Number	Depth	Width	Height	Notes
WS-MPD-BF	21	16	22	• 3/4" top standard, optional 1 1/8" top to equal 29" height
WS-MPD-FF	21	16	28.25	
WS-MPD-BBF	21	16	28.25	



### Combo File Cabinet

Model Number	Depth	Width	Height	Notes
WS-PU-BBFL	21	30.625	28.25	• 3/4" top standard, optional 1 1/8" top to equal 29" height
WS-FS-BBFL	21	30.625	28.25	

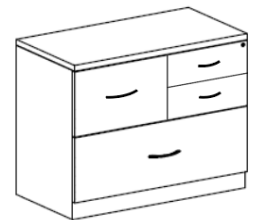

### Standard Desk Shell Lateral File

Model Number	Depth	Width	Height	Notes
WS-LATSDS30-2DR	21	30	27.5	
WS-LATSDS36-2DR	21	36	27.5	

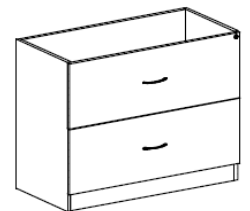

### Free Standing Lateral File

Model Number	Depth	Width	Height	Notes
WS-LATFS30-2DR	21	30	28.25	• 30" & 36" = two compartments
WS-LATFS30-3DR	21	30	40 5/8	• 42.5" = three compartments, comes with 2 pulls/2 locks
WS-LATFS30-4DR	21	30	53 1/8	
WS-LATFS36-2DR	21	36	28 1/4	• File STS for letter, FTB for legal
WS-LATFS36-3DR	21	36	40 5/8	• 3/4" top standard, optional 1 1/8" top
WS-LATFS36-4DR	21	36	53 1/8	
WS-LATFS42-2DR	21	42.5	28 1/4	
WS-LATFS42-3DR	21	42.5	40 5/8	
WS-LATFS42-4DR	21	42.5	53 1/8	

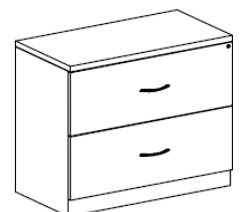

## Bookcases

Model Number	Depth	Width	Height	Notes
WS-BC1230-30	12	30	30	• 3/4" top standard, optional 1 1/8" top
WS-BC1236-30	12	36	30	
WS-BC1530-30	15	30	30	
WS-BC1536-30	15	36	30	
WS-BC1230-36	12	30	36	
WS-BC1236-36	12	36	36	
WS-BC1530-36	15	30	36	
WS-BC1536-36	15	36	36	
WS-BC1230-42	12	30	42	
WS-BC1236-42	12	36	42	
WS-BC1530-42	15	30	42	
WS-BC1536-42	15	36	42	
WS-BC1230-48	12	30	48	
WS-BC1236-48	12	36	48	
WS-BC1530-48	15	30	48	
WS-BC1536-48	15	36	48	
WS-BC1230-60	12	30	60	
WS-BC1236-60	12	36	60	
WS-BC1530-60	15	30	60	
WS-BC1536-60	15	36	60	
WS-BC1230-72	12	30	72	
WS-BC1236-72	12	36	72	
WS-BC1530-72	15	30	72	
WS-BC1536-72	15	36	72	
WS-BC1230-84	12	30	84	
WS-BC1236-84	12	36	84	
WS-BC1530-84	15	30	84	
WS-BC1536-84	15	36	84	

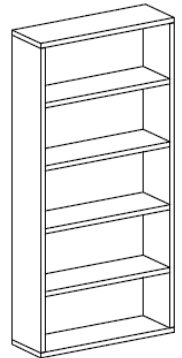
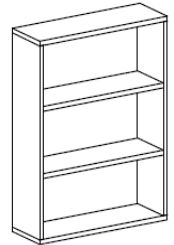
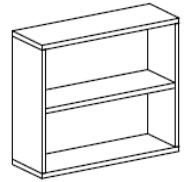

## Lateral Bookcases

Model Number	Depth	Width	Height	Notes
WS-LBC1260-30	12	60	30	• Doors available • 3/4" top standard, optional 1 1/8" top • Some assembly may be required
WS-LBC1272-30	12	72	30	
WS-LBC1560-30	15	60	30	
WS-LBC1572-30	15	72	30	
WS-LBC1260-36	12	60	36	
WS-LBC1272-36	12	72	36	
WS-LBC1560-36	15	60	36	
WS-LBC1572-36	15	72	36	
WS-LBC1260-42	12	60	42	
WS-LBC1272-42	12	72	42	
WS-LBC1560-42	15	60	42	
WS-LBC1572-42	15	72	42	
WS-LBC1260-48	12	60	48	
WS-LBC1272-48	12	72	48	
WS-LBC1560-48	15	60	48	
WS-LBC1572-48	15	72	48	
WS-LBC1260-60	12	60	60	
WS-LBC1272-60	12	72	60	
WS-LBC1560-60	15	60	60	
WS-LBC1572-60	15	72	60	
WS-LBC1260-72	12	60	72	
WS-LBC1572-72	15	72	72	

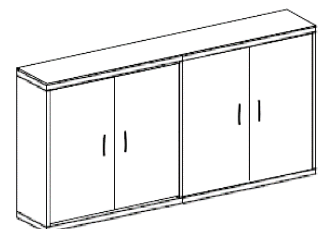
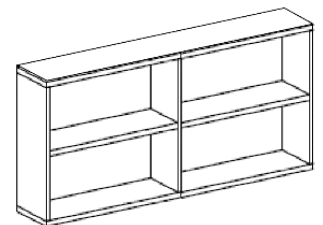

### Wall Mounted Open Overhead

Model Number	Depth	Width	Height	Notes
WS-WMO-30	14	30	16.5	<ul style="list-style-type: none"> <li>Includes cleat and valence</li> <li>Units over 36" wide will have middle divider</li> <li>60" and over come in 2 pieces</li> </ul>
WS-WMO-36	14	36	16.5	
WS-WMO-42	14	42	16.5	
WS-WMO-48	14	48	16.5	
WS-WMO-60	14	60	16.5	
WS-WMO-72	14	72	16.5	

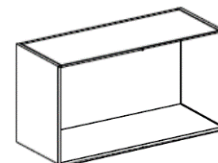

### Wall Mounted Overhead

Model Number	Depth	Width	Height	Notes
WS-WM-30	15	30	16.5	<ul style="list-style-type: none"> <li>Includes cleat and valence</li> <li>Units over 36" wide will have middle divider</li> <li>60" and over come in 2 pieces</li> <li>Depth includes doors</li> </ul>
WS-WM-36	15	36	16.5	
WS-WM-42	15	42	16.5	
WS-WM-48	15	48	16.5	
WS-WM-60	15	60	16.5	
WS-WM-72	15	72	16.5	

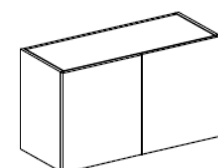

### 2-Door Credenza Cabinet

Model Number	Depth	Width	Height	Notes
WS-CC2-2130	21	30	28.25	<ul style="list-style-type: none"> <li>Depth includes doors</li> <li>Optional depths available</li> <li>Standard 3/4" top</li> <li>Optional 1 1/8" top (will not be same height as pedestals)</li> </ul>
WS-CC2-2136	21	36	28.25	

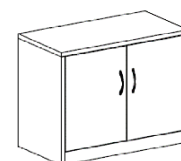

### 4-Door Storage Credenza

Model Number	Depth	Width	Height	Notes
WS-SC4-2148	21	48	28.25	<ul style="list-style-type: none"> <li>Depth includes doors</li> <li>Optional depths available</li> <li>Standard 3/4" top</li> <li>Optional 1 1/8" top (will not be same height as pedestals)</li> </ul>
WS-SC4-2160	21	60	28.25	
WS-SC4-2172	21	72	28.25	

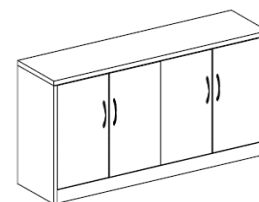

### Storage Credenza with Door/Pedestal Combination

Model Number	Depth	Width	Height	Notes
WS-SCBBF-2160	21	60	29	<ul style="list-style-type: none"> <li>Available in any combination</li> <li>Optional depths available</li> <li>Some assembly may be required</li> </ul>
WS-SCBBF-2172	21	72	29	
WS-SCFF-2160	21	60	29	
WS-SCFF-2172	21	72	29	
WS-SCCOM-2160	21	60	29	
WS-SCCOM2172	21	72	29	

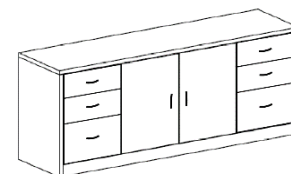

### Storage Credenza with Door/Lateral Combination

Model Number	Depth	Width	Height	Notes
WS-SCLAT-2130-30	21	60	29	<ul style="list-style-type: none"> <li>• Optional depths available</li> <li>• Some assembly may be required</li> </ul>
WS-SCLAT-2130-36	21	66	29	
WS-SCLAT-2130-42	21	72	29	
WS-SCLAT-2136-30	21	66	29	
WS-SCLAT-2136-36	21	72	29	
WS-SCLAT-2142-30	21	72	29	



### Single Door Storage Cabinet

Model Number	Depth	Width	Height	Shelves	Notes
WS-SDSC-2124-60	21	24	60	4	<ul style="list-style-type: none"> <li>• Units wider than 36" come with center divider</li> </ul>
WS-SDSC-2124-72	21	24	72	5	



### Two Door Storage Cabinet

Model Number	Depth	Width	Height	Shelves	Notes
WS-TDSC-2130-60	21	30	60	4	<ul style="list-style-type: none"> <li>• Units wider than 36" come with center divider</li> </ul>
WS-TDSC-2130-72	21	30	72	5	
WS-TDSC-2136-60	21	36	60	4	<ul style="list-style-type: none"> <li>• Optional depths available</li> </ul>
WS-TDSC-2142-60	21	42	60	4	
WS-TDSC-2148-60	21	48	60	4	
WS-TDSC-2136-72	21	36	72	5	
WS-TDSC-2142-72	21	42	72	5	
WS-TDSC-2148-72	21	48	72	5	

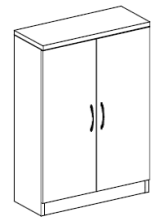

### Two Door Storage Cabinet with Lateral

Model Number	Depth	Width	Height	Shelves	Notes
WS-TDSCLAT-2136-60	21	36	60	2	<ul style="list-style-type: none"> <li>• Units wider than 36" come with center divider</li> </ul>
WS-TDSCLAT-2142-60	21	42	60	2	
WS-TDSCLAT-2136-72	21	36	72	3	<ul style="list-style-type: none"> <li>• Optional depths available</li> </ul>
WS-TDSCLAT-2142-72	21	42	72	3	
WS-TDSCLAT-2136-84	21	36	84	4	
WS-TDSCLAT-2142-84	21	42	84	4	



### 1/2 Split Two Door Wardrobe

Model Number	Depth	Width	Height	Shelves	Notes
WS-TDWR-2130-66	21	30	66	4	<ul style="list-style-type: none"> <li>• One side hanging rod, one side shelves</li> <li>• Optional depths available</li> </ul>
WS-TDWR-2136-66	21	36	66	4	
WS-TDWR-2130-72	21	30	72	5	
WS-TDWR-2136-72	21	36	72	5	



### 1/3 Split Two Door Wardrobe

Model Number	Depth	Width	Height	Shelves	Notes
WS-1/3WR-2130-66	21	30	66	4	<ul style="list-style-type: none"> <li>• One side hanging rod, one side shelves</li> </ul>
WS-1/3WR-2136-66	21	36	66	4	
WS-1/3WR-2130-72	21	30	72	5	<ul style="list-style-type: none"> <li>• Optional depths available</li> </ul>
WS-1/3WR-2136-72	21	36	72	5	

